

Cold rolled ribbed wire

CRR

Ribbed wire FeE500-2 in rolls (spools or rolls) for concrete reinforcement, welded wire mesh, concrete pipes, suitable for automatic machines (straightening and cutting machines, bending machines, etc...)

Characteristics of the ribbed wire:

Manufacturing:

It is a cold rolled wire from rods that have been hot rolled from billets.

Chemical composition and grade:

It is a low carbon wire

- Grade: SAE 1006 or SAE 1008
- Carbon lower than 0.1%
- Equivalent carbon lower than 0.25%

Mechanical characteristics:

- Re: Yield strength higher than 500MPa according to NF A35-016
- Rm: Tensile strength higher than 550MPa
- Rm/Re: higher than 1.03 according to NF A35-016
- Reduction of area higher than 30%
- Elongation at maximum load (Agt) > 2,5% according to NF A35-016
- Bendable according to NF A35-016

Geometrical characteristics:

- Permissible variation of the linear weight: +/- 4.5%

Characteristics of the ribs:

- Three rows of ribs
- Splitting coefficient $\eta = 1.3$ for $D < 6\text{mm}$ and $\eta = 1,6$ for $D \geq 6\text{mm}$
- Embedding coefficient $\psi_s = 1.5$

Range (diameter, weight kg/m)

Diameter (mm)	Weight kg/m
4	0.099
5	0.154
6	0.222
7	0.302
8	0.395
9	0.499
10	0.616
12	0.888

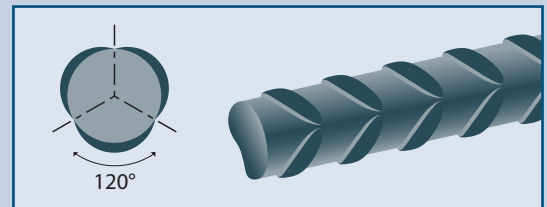

Diameter from 4mm to 8mm: packed in rolls of 100 to 600 kg weight

Diameter from 4mm to 12mm: packed in spools of 600 to 2100 kg weight

